

PDP-V402 specifications

Light emission panel 40-inch plasma display panel
Aspect ratio 4:3
No. of pixels 640 × 480 (adaptable to VGA)
Pixel pitch
 1.26 (horizontal, RGB trio) × 1.26 (vertical) mm
No. of gradations 256 gradations/
 16,770,000-color full color
View angle Horizontal : 160° or more
 Vertical : 160° or more

Input/output terminals

RGB Input

- ① BNC Terminal R, G, B (fixed to 75 Ω input)
 - Analog R, G, B (fixed 75 Ω input, G-on Sync input)
 - HD (H/V SYNC), VD (switching between 75 Ω /2.2 kΩ input)
 - Switch VD according to the sync output impedance of the connector. Switch VD to 2.2 kΩ except when the sync output impedance is 75 Ω. (The terminal is factory-set to 75 Ω.)
- ② Mini Dsub 15P
 - Analog RGB, 0.7 Vp-p, 75 Ω input, G-on Sync input (Sync 0 - 3 Vp-p)
 - Synchronization:
 - HD, VD 2.2 kΩ input, 2.0 - 5.0 Vp-p (Positive/Negative), G-on Sync switch (G-on Sync ON/OFF Change over)
 - Turn the switch on only if images become greenish (when the G-on Sync signal is applied) at RGB2 input. Under normal circumstances, the switch is left off. (The switch is factory-set to G-on Sync OFF.)

Video input Single-system BNC terminal 75 Ω input
 Composite 1 Vp-p
 Y/C input Double-system BNC terminal 75 Ω input
 Control input Dsub 9P (RS232C control)
 Video output Single-system BNC terminal 75 Ω output
 (Note: Up to four units, including the unit to which the signal is first input, may be connected when the equipment is connected in series using this output terminal. However, increasing the number of connected units may increase the noise.)

Applicable sources

- ① Video system: NTSC
- ② Computer system
 - 1. Resolution
 - AT-compatible: VGA (640 dots × 480 lines)
 - Macintosh®: 13-inch mode (640 dots × 480 line)
 - PC-9800®: Normal mode (640 dots × 400 line)

- 2. Synchronizing frequency:
 - AT-compatible: 31.5 kHz (horizontal), 60 Hz (vertical)
 - 37.9 kHz (horizontal), 72.8 Hz (vertical)
 - 37.5 kHz (horizontal), 75 Hz (vertical)
 - Macintosh®: 35 kHz (horizontal), 66.7 Hz (vertical)
 - PC-9800®: 24.8 kHz (horizontal), 56.4 Hz (vertical)
 - 31.5 kHz (horizontal), 70.1 Hz (vertical)

Does not accommodate the interlaced mode of the computer.
 Some types of computer have multiple indication modes. However, some modes cannot be displayed even if the computer meets the specifications. Please contact your dealer for further information.

Power source 100 to 120 V AC, 50/60 Hz

Inrush 70 A or less

Power factor 0.95 or more

Power consumption 350 W (in standby: 2 W)

Outer dimensions 916 (W) × 714 (H) × 88 (D) mm

Weight 30.8 kg

Operating environment temperature range

..... 0 to 40 °C

Operating environment humidity range

..... Relative humidity 20% to 80%

Operating environment air pressure range

..... 0.8 - 1.1 atmospheric pressure

Storage conditions (plasma display panel alone)

Storage ambient temperature range

... -20 to 45°C (Temperature gradient (0°C/hr. or less))

Storage ambient humidity range

..... 20 to 90% (without condensation)

Storage ambient air pressure range

..... 0.6 - 1.5 atmospheric pressure

Storage conditions (Package state)

Storage environment temperature range

..... -40 to 60 °C

Storage environment humidity range

..... Relative humidity 20% to 90%

Storage ambient air pressure range

..... 0.6 - 1.5 atmospheric pressure

Storage stack limit maximum of 10

Accessory

- Power cord 1
- Remote control 1
- Remote control case 1
- AA battery 2
- Stand 2
- Bolt 2
- Washer 2
- Cable clamp 3
- Operating Instructions 1

- Specifications and appearance are subject to change without notice.

Outline drawing

Plasma display main body weight : 30.8 kg

Material : Front - Plastic, Back - plate

Treatment : Front - Leather satin gray paint, Back - Semi-matte black paint

Packing specifications - See " 3.3.2 Unpacking "

 : Location of center of gravity

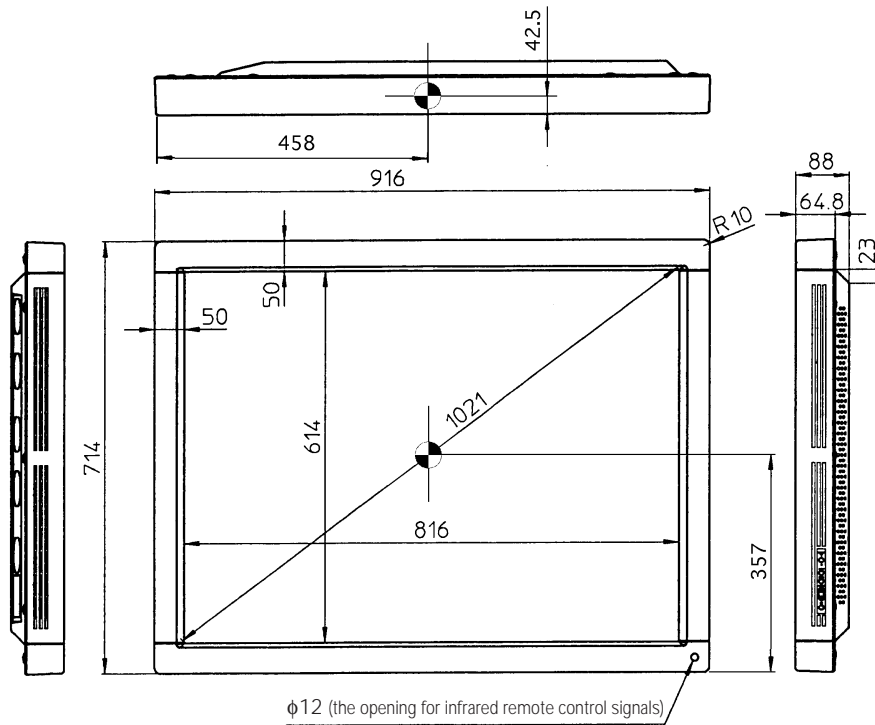

<Light-accepting section of the remote controller>

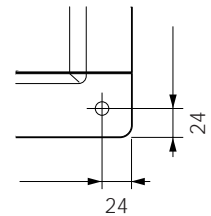

<Operation panel of the main body>

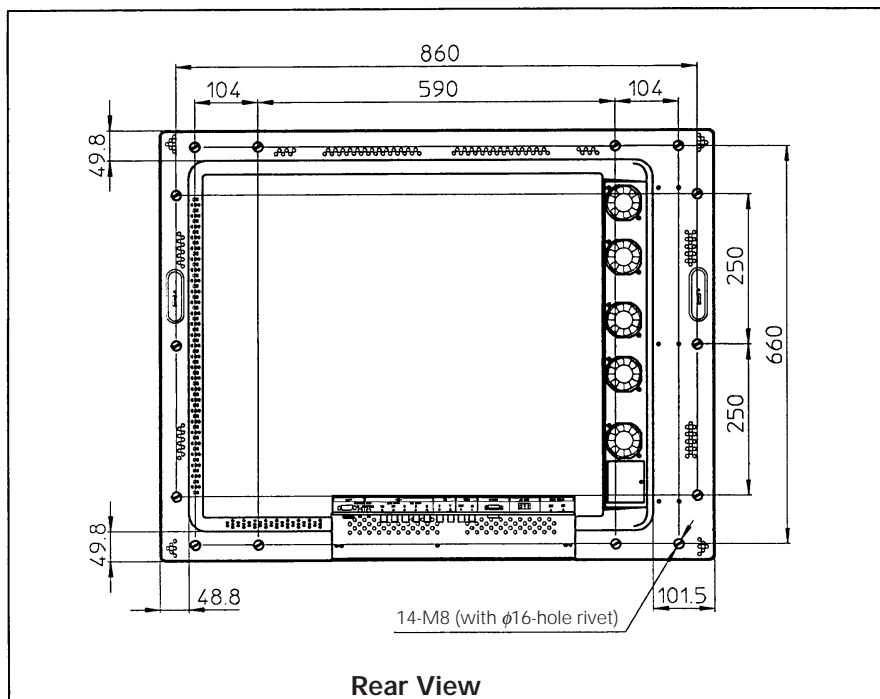
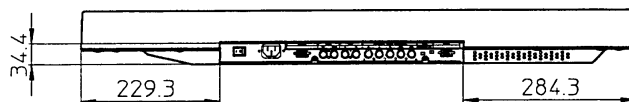
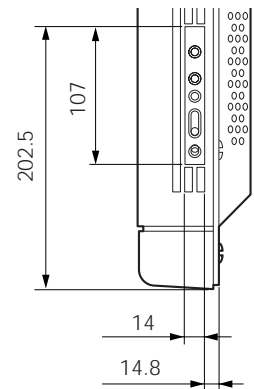

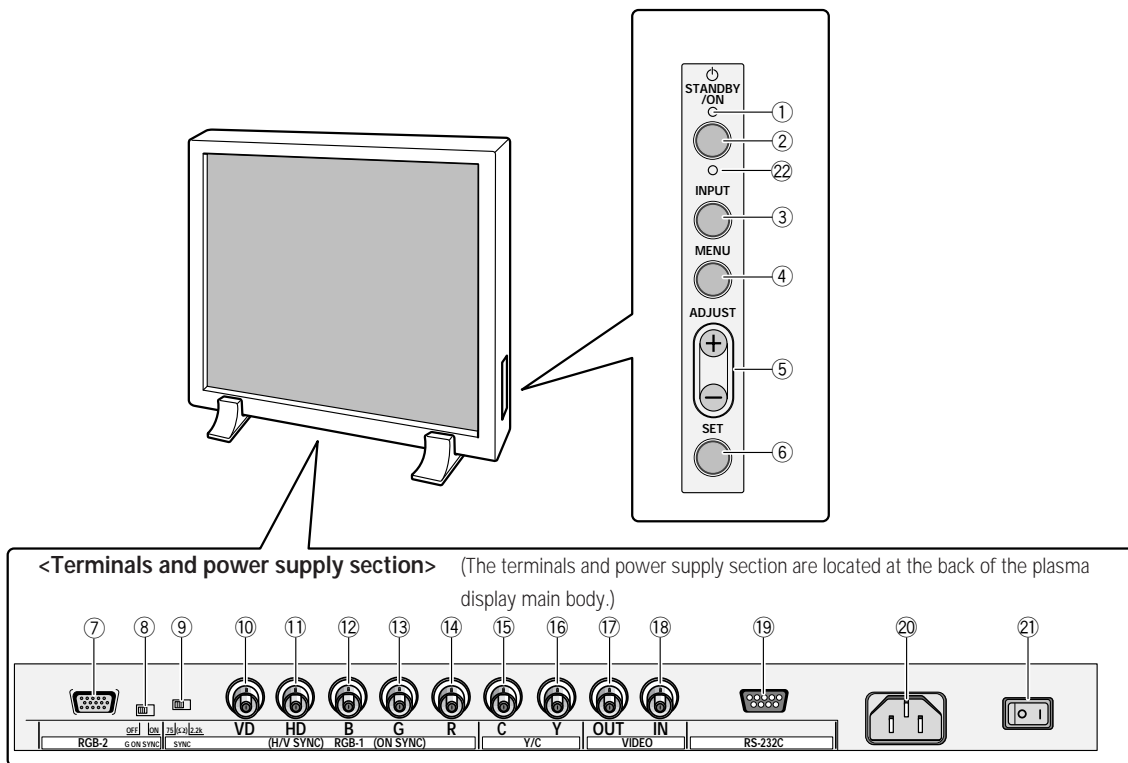

<Control Panel>

① STANDBY/ON indicator

The indicator is red when in standby mode and turns green when the power to the display is turned on.

② STANDBY/ON button

Press to turn the power to the display on and off.

③ INPUT button

Press to switch the various input functions.

④ MENU button

Press to enter the menu screen and exit from it.

⑤ ADJUST button

Use the +/- buttons to adjust picture quality.

⑥ SET button

Press to finalize menu selections when adjusting picture quality.

<Rear Panel Terminals/Connections to Power Source>

RGB-2 input terminals

⑦ Remote control out switch (ON/OFF)

This switch will output remote control commands from the RGB-2 (D-SUB 15-pin) terminal to control external peripheral devices planned for future sales release. Normally be sure to use set to OFF.

⑧ MINI D-SUB 15-pin terminal

⑨ G on Sync mode selection switch (ON/OFF)

If the images become greenish when an external device is connected to the RGB-2 input terminal, turn ON the G on SYNC mode. Normally set to OFF.

RGB-1 input terminals

⑩ Sync Signal Input Impedance switch (75 W/2,2 kW)

⑪ Vertical Sync Signal Input terminal: (75 W/2,2 kW, switchable with the Sync Signal Input Impedance switch)

⑫ Horizontal or Composite Sync Signal Input terminal: (75 W/2,2 kW, switchable with the Sync Signal Input Impedance switch)

⑬ Blue Signal Input terminal: 75 W

⑭ Green or Green with Sync Signal Input terminal (ON SYNC) :75 W

⑮ Red Signal Input terminal: 75 W

Y/C input terminals

⑯ Color Signal Input terminal: 75 W

⑰ Luminance Signal Input terminal: 75 W

VIDEO input/output terminals

⑱ Video Output terminal: 75 W

⑲ Video Input terminal: 75 W

⑳ Control Signal Input terminal (RS-232C)

㉑ AC inlet

㉒ MAIN POWER switch