

35HD and MMS 1000



PROJECTOR PERFORMANCE SPECIFICATIONS

Brightness (±10%)

20,000 Center lumens
18,000 ANSI lumens
Further increases targeted

Contrast Ratio (±10%)

1600:1 full field

Display Type (one per R, G, B)

3 x 1.26" dark metal HPO DMD™

DMD Specification

2048 x 1080 pixels native, 12° tilt angle

Fill factor

90% pixel fill factor

Lamp Type

Proprietary xenon arc, bubble

Lamp Life¹

750 hours (typical)

Lens Mount

Intelligent, programmable lens functionality
Motorized horizontal and vertical
lens shift, zoom and focus

Operator Touch Screen

With "ShowMode" diagnostics -
provides direct control and feedback
over projector functions

Lens Shift (typical, dependent on lens)

Vertical: ± 0.25-0.5 frame
Horizontal: ± 0.1-0.25 frame

Lens Options

1.0 :1 fixed
1.25-1.45:1 zoom
1.45-1.8 :1 zoom
1.8-2.2 :1 zoom
2.2-3.0 :1 zoom
3.0-4.3 :1 zoom
5.5-8.5 :1 zoom

Mechanical Mounting

Floor or ceiling, integrated handles and
rigging frame with pitch and roll adjustments,
flexible stacking/rigging points

Dimensions (excluding frame)

1097mm(L) x 721mm(W) x 434mm(H)
43.2in(L) x 28.4in(W) x 17.1in(H)

Weight (chassis only)

113kg (249lbs)

Digital Projection International, Texas Instruments' first DLP™ partner and the original innovator of the 3-chip DLP™ projector, proudly introduces our third-generation LIGHTNING series — the LIGHTNING 35HD. Incredibly bright, resolute and high in contrast, the 35HD offers a radically new electronics configuration ideally suited for the staging and large-venue permanent installation markets.

The LIGHTNING 35HD harnesses the power of Texas Instruments' new 2048 x 1080 pixel HPO DMD's™. Like its LIGHTNING predecessors, the 35HD is destined to be the first choice of professionals who stage prestigious events such as the Grammy® Awards and the Oscars®. With contrast of 1600:1 and awe-inspiring lumen capability, the 35HD is unmatched for applications as diverse as world class staged events, commercial entertainment, major outdoor venues, large-scale simulation, gaming and houses of worship.

When paired with the Multi-Media Switcher 1000 (MMS 1000), the new LIGHTNING 35HD can support any analog, digital video, HD or computer source. The easy-to-use, rack-mountable system includes DigiLink, a single-wire, ultra-high bandwidth digital output to the projector, dramatically simplifying system wiring and reducing installation costs. Beyond its multi-input capabilities, the MMS 1000 includes soft-edge blend and can also be configured to incorporate advanced options such as seamless cross-fade between sources and user definable geometric warp.

The LIGHTNING 35HD and MMS1000 — an ultra-powerful display system for major events and applications — bringing the precision of Digital Projection to every venue.

MULTI-MEDIA SWITCHER 1000 SPECIFICATIONS

▶ Input capabilities-see table lower right

Video Processing

10-bit processing from video input to output
DigiScale - accurate image resizing for faithful reproduction of all displayed sources
DigiView - optimized video processing, deinterlacing and 3:2 pull-down

Edge Blending

DigiBlend - edge blending for tilting of multiple projected images

Geometry

DigiWarp (optional) - user definable control over all image geometry. Horizontal/vertical and keystone warp correction for both cylindrical and spherical displays

Interface To Projector Via DigiLink

High-bandwidth digital link extendable by rugged fibre optic cable providing optically-isolated interconnection. Offering significant benefit to staging and installation customers by reducing cable complexity and signal interference due to grounding

Control

Front panel LCD, IR/Hardwired remote control, external control via RS232/422, USB or LAN

PC Card Slot

Wireless LAN, data download

Dimensions

Five RU 19" rack mountable
450mm(L) x 483mm(W) x 221mm(H)
in(L) x in(W) x in(H)

INPUT CAPABILITIES

Type	Connector	Quantity
Projector input:		
DigiLink-digital RGB dual link	DVI-Dx2	1
MMS 1000 input/output:		
Four available input slots:		
standard modules:		
Composite / component video / S-video input module (mm-video)	BNCx1,BNCx3, 4-pin mini DIN	1 each
RGB HV / component input module (MM-RGB)	BNCx5	1
optional modules:		
DVI-D input module (MM-DVI)	DVI-D	1
SD-SDI / HD-SDI input module (MM-SDI)	BNCx2	1
Output:		
DigiLink	DVI-D	1

▶ Specifications subject to change without notice DP V2.04/04 ©2004 Digital Projection, Inc.

™DLP, Digital Light Processing and DMD are trademarks of Texas Instruments, Inc.

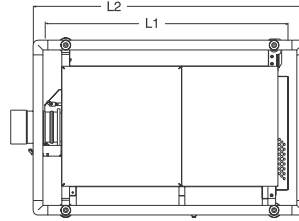
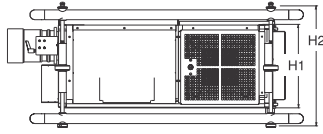
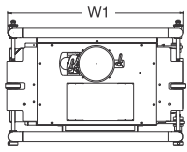

Projector dimensions (mm)
W1 721 H1 434 L1 1097

Projector dimensions (in)
W1 28.4 H1 17.1 L1 43.2



Frame dimensions (mm)
W1 721 H2 475 L2 1103

Frame dimensions (in)
W1 28.4 H2 18.7 L2 43.4



Lightning 35HD back panel

ADVANCED TECHNICAL SPECIFICATIONS

PARAMETER		
Color Temperature	3000-9300°K	NA
HDTV Formats Supported	1080i/24p, 720p, 480p and other current and emerging formats	
Scan Rates Supported	Horizontal: 15kHz to 105kHz / Vertical: 24Hz to 110Hz	
Remote Control	Addressable infra-red remote control	
Automation Control	RS232, USB, LAN via Multi-Media Switcher 1000	
Operating/Storage Temperature	Operating: 10 to 35°C / Storage: -10 to 50°C	Operating: 10 to 35°C / Storage: -20 to 60°C
Operating Humidity	up to 80% non-condensing	
Thermal Dissipation	13640 BTU	1023 BTU maximum
Fan Noise	Less than 59dBA	NA
Power Requirements	208-264 VAC, 50/60Hz single phase	100-240 VAC, 50/60Hz single phase
Power Consumption	4000 watts	300 watts maximum

PROJECTOR	PART NO.	LENSES	PART NO.	OPTIONAL SYSTEM COMPONENTS	PART NO.
LIGHTNING 35HD	102-278	1.0 :1 fixed	103-350	Replacement Lamp	LM00519
		1.25-1.45:1 zoom	103-351	MMS 1000	001-724
		1.45-1.8 :1 zoom	102-451	Input cards:	
		1.8-2.2 :1 zoom	102-676	- Composite / component /	001-726
		2.2-3.0 :1 zoom	102-677	- S-Video input module (MM-Video)	
		3.0-4.3 :1 zoom	102-678	- RGB HV / component input module (MM-RGB)	001-722
		5.5-8.5 :1 zoom	103-352	- DVI-D input module (MM-DVI)	001-721
			- SD-SDI / HD-SDI input module (MM-SDI)	001-720	
			Processing options:		
			- Seamless switching / crossfade: ²		
			• Scaler	001-729	
			• Image processor	001-730	
			- Geometry / Warp ³	001-727	
			- Wireless LAN card	001-723	



MMS 1000

1 See Digital Projection's Product Warranty Statement for details on lamp warranty
2 Seamless switching requires the addition of two cards (image processor / scaler) which must be factory fitted
3 Geometry / warp is available only as a factory installed option